

Cabinets & Racks

Outdoor Floor Cabinets - Model E 32U



Floorstanding cabinet model E 32U is an outdoor model IP64 rated, designed to withstand all types of weather conditions to keep it protected from dust, and wind driven rain. Model E is an air conditioned cabinet designed for outdoor applications.

Features & Benefits

- IP64 rated
- Comes pre-assembled
- Weight 43kg
- Can withstand working temperatures of -40 to +55°C
- Protection from dust, wind and wind driven rain
- Outdoor application
- Precise dimensions and craftsmanship
- Available in grey or black - other colours available upon request



Technical Specifications

Dimensions, Weight & Mount		
External Dimensions (Height x Width x Depth)	mm	1100x430x195
External Dimensions (Height x Width x Depth) with Flange	mm	1141x471x195
Weight	Kg	43
Mounting Method		Door Mounted
Application		Outdoor
Environmental Protection & Performance		
Working Temperature Range	°C	-40 to +55
Noise Level	dB(A)	65
Protection from Dust, Water and Wind Driven Rain		IP64
Refrigerant		R134a
RoHS Compliant		Yes
Cooling/Heating Capacity		
Cooling Capacity@L25/L35	W	\
Cooling Capacity@L35/L35	W	1500
Heating Capacity (Optional)	W	1000
Power Consumption		
Power Consumption@L25/L35	W	\
Power Consumption@L35/L35	W	630
Current@L25/L35	A	\
Current@L35/L35	A	3.00

Cabinets & Racks

Outdoor Floor Cabinets - Model E 32U

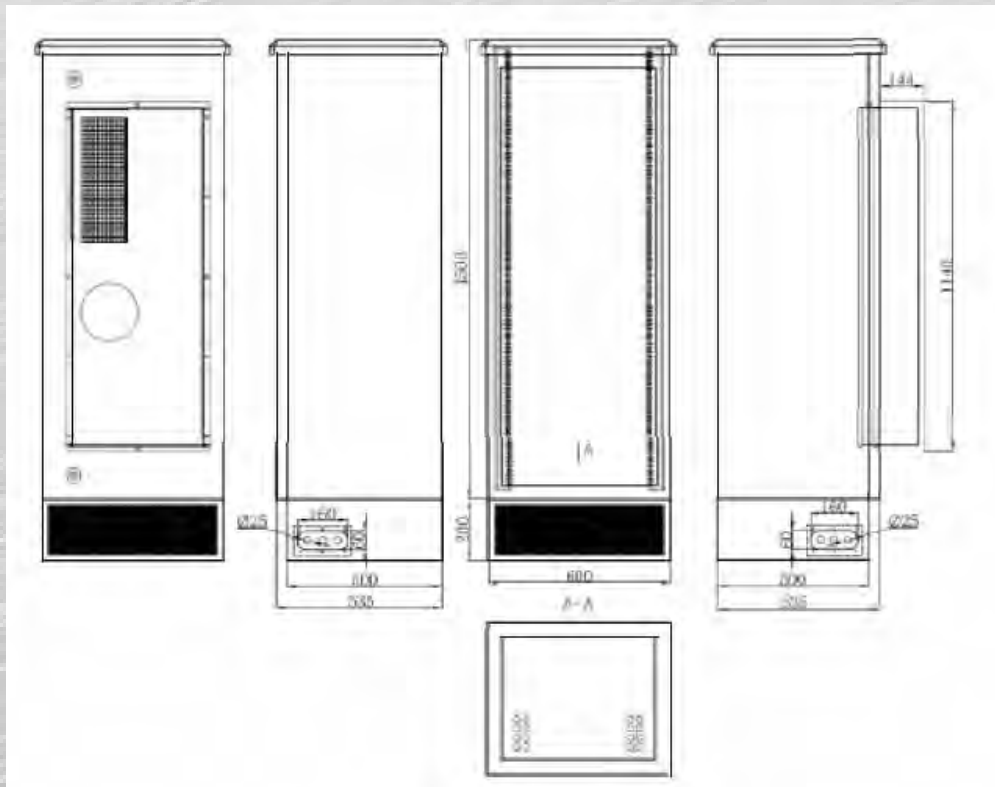
Airflow		
Internal Airflow	M3/h	350
Power Supply		
Power Supply Range	VDC	-40 to +55, 50/60
Rated operating voltage - Controller	VDC	48
Rated operating voltage - Cooling/Heating System	VDC	48
Max. Current	A	4.0
Key Components		
Controller		Envicool
Fans		Telecom Level
Compressor		Telecom Level
Heater		Telecom Level
External Materials		
Sheet Metal Parts		SECC + Powder Painting
Colour (Optional)		RAL7035

Technical Drawings

For any queries, please contact Technoline Solutions team using the details below.